

PRODUCT DATA SHEET

MX25P-2HE - 1" DIGITAL FLOW METER WITH PRA DISPLAY

The MX Series 1" DIGITAL FLOW METER are suitable for flows between 6 – 120 L/min (1.59 - 31.70 GPM), providing highly accurate flow measurement performance. The MX Series offers $\pm 0.5\%$ accuracy of true reading in a compact footprint, requiring no flow conditioning and with high pressure and temperature capabilities.

Key features include:

- Stainless Steel (316) construction
- FEP Encapsulated seals
- Maximum flow rate 120 L/min / 31.70 GPM
- Accuracy of $\pm 0.5\%$ of reading
- Exceptional repeatability of $\pm 0.03\%$
- Temperature up to 80 °C / 176 °F
- 1 point factory calibration as standard, with additional points upon request

SPECIFICATIONS



MX25P-2HE

	MX25P-2HE			
Material of construction	Meter Body	Stainless Steel (316)		
	Rotor	PPS		
	Seals	FEP Encapsulated		
Design Specifications				
Process Connections	1" NPT Thread			
Technical Specifications		min	max	
	Flow rate < 5cPr	10	100	L/min
		2.64	26.42	GPM
	> 5cP	6	120	L/min
		1.59	31.70	GPM
	Non lubricating fluids	-	120	L/min
		-	31.70	GPM
	Operating Temperature Range**	-40	80	°C
		-40	176	°F
	Accuracy (±%)	±0.5%		
Repeatability (±%)	±0.03%			
Nominal K-Factor	36 Pulses/Litre			
	136.31 Pulses/Gallon			

OUTPUT TYPE



PRA DISPLAY

PRA [LCD 12mm display]	
Construction	Polypropylene
IP Rating	IP67
Temp	Min: -20 Max: 60 °C Min: -4 Max: 140 °F
EX Approvals	- Please refer to instruction manual and certification documentation for product appropriate certification information
Display	
Digit size (upper/lower)	12mm/8mm
Accumulated total	✓
Resettable total	✓
Preset total	✗
Flow rate	✓
Outputs	
4-20 mA (passive)	✓
Pulse/Transistor Output	✓
Flow Alarm	✓
Batch Control output	✗

PRODUCT DATA SHEET

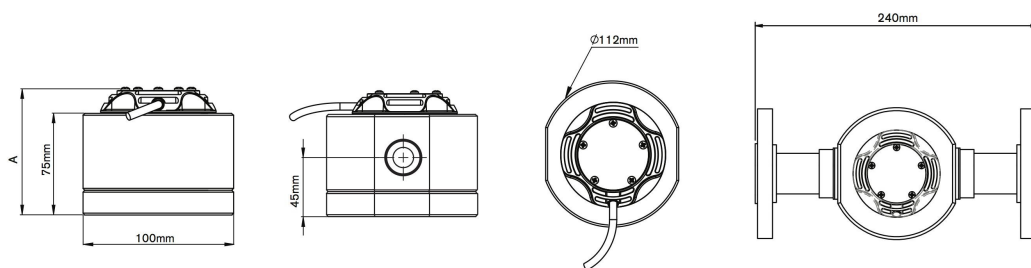

PULSER AND DISPLAY HEIGHT - A

OUTPUT A,I,J,K
PULSER - Standard

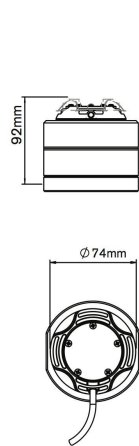

OUTPUT B
PULSER - Exia

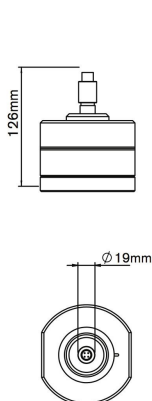

OUTPUT C
PULSER - EXd

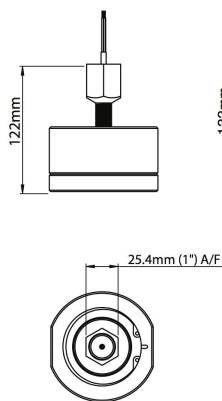

OUTPUT N
PULSER - Exia

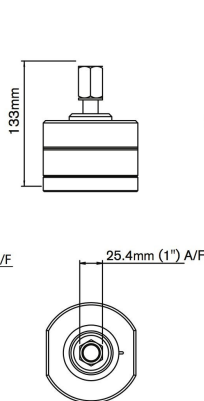

OUTPUT T
PULSER - High Temp.

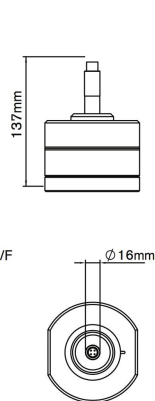

OUTPUT D,E
DISPLAY - LCD 12mm

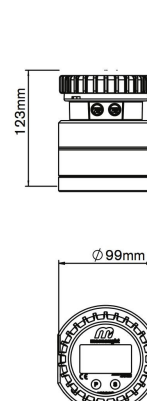

OUTPUT F,G,H DISPLAY
- LCD 17mm

