

PRODUCT DATA SHEET

MX06P-2SG - 1/4" DIGITAL FLOW METER WITH ERA DISPLAY

The MX Series 1/4" DIGITAL FLOW METER are suitable for flows between 0.5 – 100 L/hr (0.13 - 26.42 GPH), providing highly accurate flow measurement performance. The MX Series offers $\pm 0.5\%$ accuracy of true reading in a compact footprint, requiring no flow conditioning and with high pressure and temperature capabilities.

Key features include:

- Stainless Steel (316) construction
- FEP Encapsulated seals
- Maximum flow rate 100 L/hr / 26.42 GPH
- Accuracy of $\pm 0.5\%$ of reading
- Exceptional repeatability of $\pm 0.03\%$
- Temperature up to 80 °C / 176 °F
- 1 point factory calibration as standard, with additional points upon request

SPECIFICATIONS



MX06P-2SG

	MX06P-2SG			
Material of construction	Meter Body	Stainless Steel (316)		
	Rotor	PPS		
	Seals	FEP Encapsulated		
Design Specifications				
Process Connections	1/4" NPT Thread			
Technical Specifications		min	max	
	Flow rate < 5cPr	2	100	L/hr
		0.53	26.42	GPH
	> 5cP	0.5	100	L/hr
		0.13	26.42	GPH
	Non lubricating fluids	6	100	L/hr
		1.59	26.42	GPH
	Operating Temperature Range**	-40	80	°C
		-40	176	°F
	Accuracy (±%)	±0.5%		
Repeatability (±%)	±0.03%			
Nominal K-Factor	1000 Pulses/Litre			
	3,786.44 Pulses/Gallon			

OUTPUT TYPE



ERA DISPLAY

ERA [LCD 17mm display]	
Construction	Aluminium
IP Rating	IP67
Temp	Min: -40 Max: 80 °C Min: -40 Max: 176 °F
EX Approvals	- Please refer to instruction manual and certification documentation for product appropriate certification information
Display	
Digit size (upper/lower)	17mm/8mm
Accumulated total	✓
Resettable total	✓
Preset total	✗
Flow rate	✓
Outputs	
4-20 mA (passive)	✓
Pulse/Transistor Output	✓
Flow Alarm	✗
Batch Control output	✗

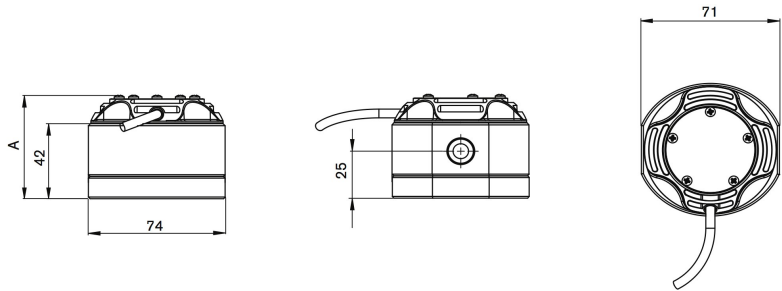

PULSER AND DISPLAY HEIGHT - A

OUTPUT A,I,J,K
PULSER - Standard

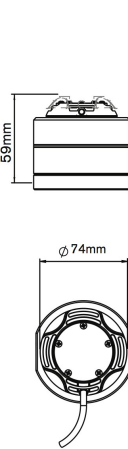

OUTPUT B
PULSER - Exia

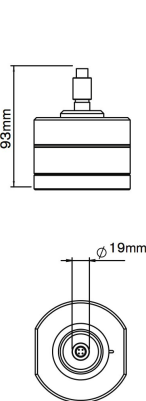

OUTPUT C
PULSER - EXd

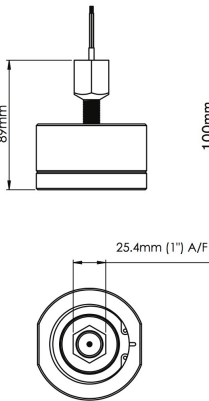

OUTPUT N
PULSER - Exia

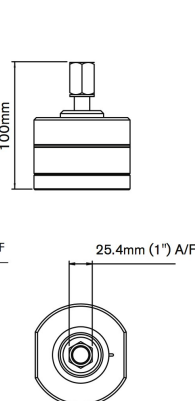

OUTPUT T
PULSER - High Temp.

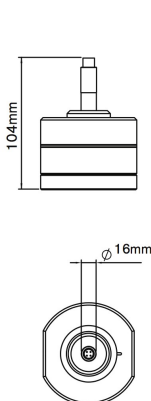

OUTPUT D,E
DISPLAY - LCD 12mm

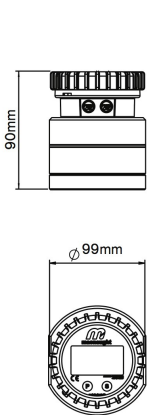

OUTPUT F,G,H DISPLAY
- LCD 17mm

